



AVAILABLE ON GET IT ON Google Play & Download on the App Store & amazon alexa

Smart IntelliFlow™ Fan Kit

User Manual

Smart Bharat Best Smart IntelliFlow® Fan Kit

Smart IntelliFlow™ Fan Kit is Voice controlled, Smart App Controlled and comes with a Remote. It will fit inside the cup of the fan. You can access your fan via Smart Bharat Best Smart App from anywhere as it is Wi-Fi enabled, Set different modes and speed as per your comfort.

Features :

- ☞ Auto ON/OFF with Smart Timer
- ☞ Auto ON/OFF with Dusk/Dawn
- ☞ Integrated MPU to save energy
- ☞ Routine Schedule
- ☞ Wi-Fi Enabled
- ☞ Buy Function for Consumer
- ☞ 100% Warranty Details
- ☞ End to End Turnkey Solution
- ☞ OTA Enabled
- ☞ Bluetooth Enabled
- ☞ Dual Core SOC
- ☞ Multi-Languages
- ☞ Multiple Themes
- ☞ Product Life Cycle Detection
- ☞ Compatible with IOS, Android & Alexa
- ☞ Built in Easy Service Registration Ticketing System.
- ☞ Power and Appliance Usage Reporting
- ☞ Child Profile
- ☞ Built-in 2-Factor Authentication
- ☞ Can work without Wi-Fi with IR Remote
- ☞ Weather Safety Alerts
- ☞ Data Privacy
- ☞ Log activity and reboot logs are available in the Smart App
- ☞ Free Firmware Upgrades

IMPORTANT INFORMATION

Cautions : Risk of ELECTRONIC SHOCK OR BURNS - USE IN DRY LOCATION ONLY. Do not use outdoors, with wet hands, or when standing on wet surface. Please make sure voltage is compatible with main electricity of your location/locality before connecting.

QUICK START
Step 1 : Download Smart Bharat Best App from App Store or Google Play Store.

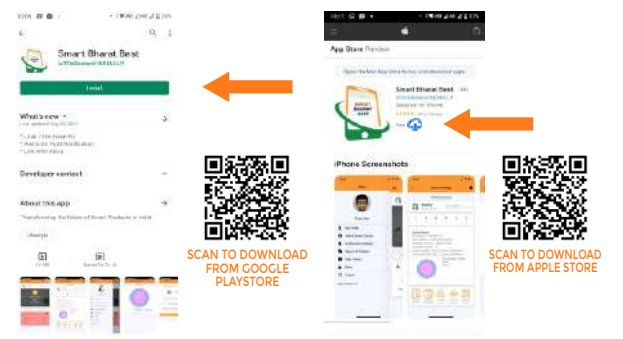

GOOGLE PLAY STORE APP STORE

Step 2 : After downloading the App, open the application & click on Sign Up from Login Screen.

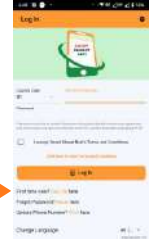

Step 3 : Fill all the required fields & then click on Sign Up button.

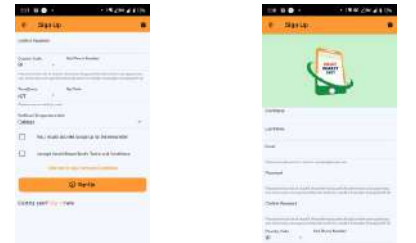

SIGN UP SCREEN SIGN UP SCREEN

Step 4 : Now enter the OTP sent to your registered mobile number & click on verify button.

OTP SCREEN



Step 5 : Verify the email by clicking on link sent to registered email & then click on (I've Verified Email) button.

VERIFY EMIAL SCREEN



NEXT STEP IS TO REGISTER YOUR DEVICE

Step 6 : Now select your device from the list & click on connect button. For adding a device you need : (1) Enable Bluetooth and Locations service on phone. (2) Wi-Fi Password to connect to your Wi-Fi.

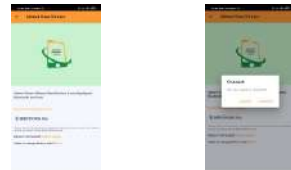

Step 7 : Now select your Wi-Fi and enter password to connect. You will find your registration successful.



Note : Once device is Registered for first time, It may take around 10 minutes to update Firmware to latest version. Device will reboot and come online once firmware update is complete.

RESET YOUR DEVICE

Soft reset device through Smart Bharat Best Application

1. Click on device setting from application.
2. Go to configure Device.
3. Click on reset all service reboot.
4. Type yes and click on ok button.

FACTORY RESET DEVICE

Press and hold reset button for 5 seconds while device is powered On and the fan is in OFF state. This will clear all Configuration / Registration details from the Device.

ELECTRICAL INSTALLATION GUIDE

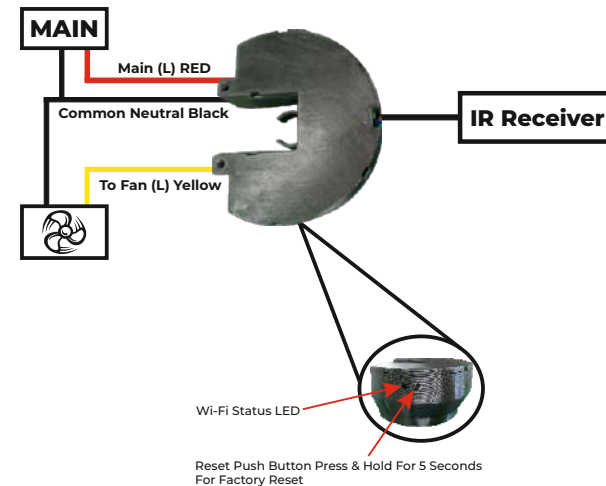

MOUNTING GUIDE

STEP 1

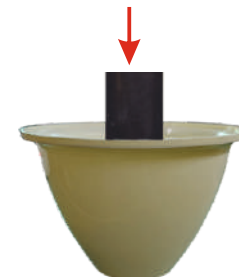

STEP 2

Place the IR sensor outside the cup as shown below

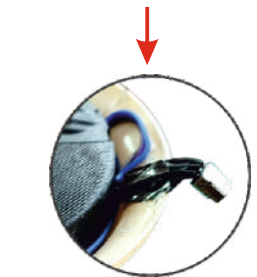

INDIA: 35, Industrial Area, Phase -2, Chandigarh – 160002

info@smartbharatbest.com

+91-913-723-7443

www.smartbharatbest.com

